



Roll On Rainscreen™

Installation Instructions

Product Description:

Roll-On Rainscreen™ is a non-structural corrugated aluminum strip with the ability to drain both vertically and horizontally. Roll-On's 3/8" air gap allows for optimal air-flow & drainage while saving time and money on buildout! Our universal strip is utilized for the top/bottom vents as well as the furring.

Mill Finish: 0.024" thick aluminum

Dimensions: 1.5" wide, 3/8" tall

Material Specifications:

- AAMA Specification 1405.1 for Aluminum Coil
- FHA Minimum Property Standard 4900.1 One and Two Family Dwellings
- FHA Minimum Property Standard 4910.1 for Multi Family Dwellings
- 0.024" nominal thickness 3105-type alloy Aluminum Sheet with minimal tensile strength of 24,000 psi

Tools needed:

- Level
- Chalk Line/Laser
- Tin Snips
- Hammer/Nail Gun
- Cordless Drill
- Tape Measure

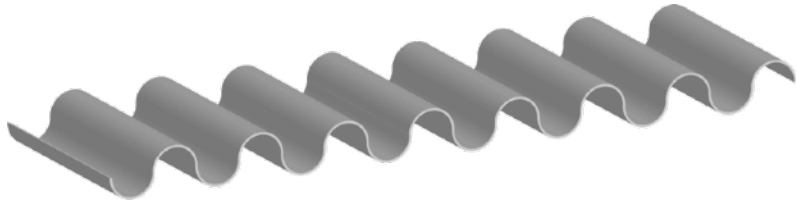

Fasteners needed:

- 2.5" Double Hot Dip Galvanized Smooth Shank Nail
- We recommend Pre-Drilling all Fiber Cement claddings to avoid blowout

Job Site Safety & Preparation:

Always wear eye protection and gloves. Make sure the wall is free from any structural defects and all membranes or flashing are properly installed per manufacturers requirements. Roll-On Rainscreen™ should only be applied to OSB/Plywood or over code compliant insulation up to 1" thick maximum. Before installation, check with your local building code requirements and read all manufacturers installation instructions.

IMPORTANT:

Failure to follow GGGs LLC written installation instructions in accordance with project engineer/architect/owner recommendations and applicable building codes may violate local laws, affect building envelope performance, and void warranty coverage. Every project is unique and the full details of each should be taken into consideration on a case-by-case basis by the architect, engineer, contractor, and installer along with these general installation instructions. GGGs LLC is not responsible for any moisture damage or structural failure within the wall assembly resulting from improper installation. Failure to comply with all health and safety regulations when cutting and installing this product may result in personal injury. GGGs LLC is not responsible or liable for any injuries or loss of any kind with use of any of GGGs LLC's products. Before installation, confirm you are using the correct product instructions by visiting www.rollonrainscreen.com

HORIZONTAL INSTALLATION

Installing Bottom StarterStrip™

- Measure 2" up from the bottom of sheathing on both sides of the wall
- Snap a chalk line from one end to the other (make sure line is level and straight)
- Measure and cut StarterStrip™ to the length of the wall
- Line up the bottom edge of the StarterStrip™ with the bottom of the sheathing
- Nail every 16" into the framing
 - *The nails need to be 3/4" up from the bottom of the StarterStrip™*



Installing Roll-On Rainscreen™ (RORS) Horizontally

- Measure and cut a piece of RORS to the length of the wall for the starter course
- Start application of RORS from left to right, over top of StarterStrip™
 - *make sure the **top** edge of RORS is lined up with the chalk line
- Nail every 16" into the framing
- Measure 16" up from your initial chalkline on each side of the wall
- Snap a new chalkline
- Repeat previous steps continuing installation of RORS up the wall, every 16"



Outside Corner - Horizontal Install

- When two walls meet at an outside corner,
- Repeat RORS installation steps on one of the adjoining walls, ending at the corner
 - Begin the connecting course of RORS on the adjoining wall at the corner where the initial course ends

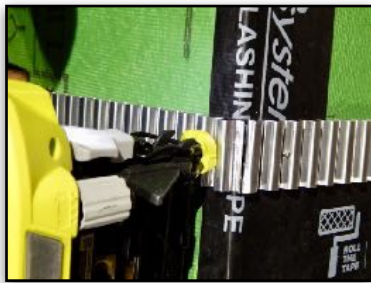

Inside Corner - Horizontal Install

- When two walls meet at an inside corner,
- Repeat RORS installation steps on one of the adjoining walls, ending at the corner
 - Begin the connecting course of RORS on the adjoining wall at the corner where the initial course ends



Installing Top StarterStrip™

- Measure 1/4" down from soffit
- Snap chalkline
- Line up top* of the StarterStrip™ with the chalk line
 - *this will be inverted compared to the initial installation
- Nail every 16" into the framing
- Install final piece of RORS over the inverted StarterStrip™ by lining up the top edge of RORS with the angle in the starter vent
- Nail every 16" into the framing



VERTICAL INSTALLATION

Installing Bottom StarterStrip™

- Measure 2" up from the bottom of sheathing on both sides of the wall
- Snap a chalk line from one end to the other (make sure line is level and straight)
- Measure & cut StarterStrip™ to the length of the wall
- Line up the bottom edge of the StarterStrip™ with the bottom of the sheathing
- Nail every 16" into the framing
 - *The nails need to be 3/4" up from the bottom of the StarterStrip™*

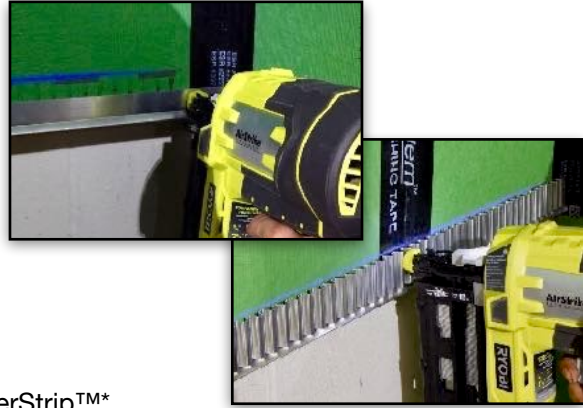

Installing Top StarterStrip™

- Once you have reached the top of the wall, measure down 1/4" from soffit and snap chalkline
- Line up angled bottom of the StarterStrip™ with the chalk line (this will be upside down compared to the initial application)
- Nail every 16" into the framing
- Install final piece of RORS by lining up the top with the angle in the starter vent
- Nail every 16" into the framing

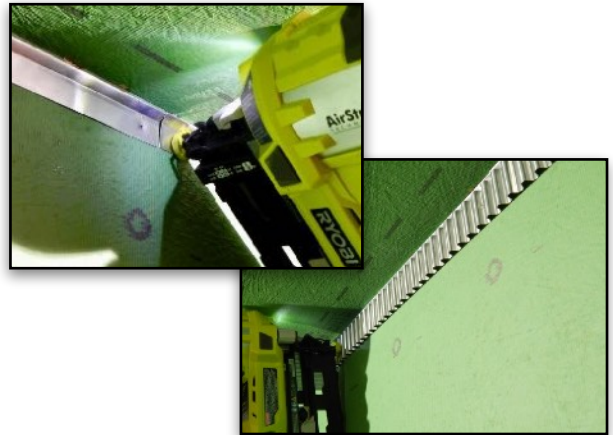

Installing Roll-On Rainscreen™ (RORS) Vertically

- Measure & cut a piece of RORS to the length of the wall for the starter course
- Start application of RORS from left to right
 - *make sure the top edge is lined up with the chalk line
- Nail every 16" into the framing
- Measure 16" left/right from your initial chalkline on top & bottom of the wall
- Snap a new chalkline
- Repeat previous steps continuing installation of RORS across wall, every 16"



Inside Corner - Vertical Install

When two walls meet at an inside corner,

- If using aluminum trim, install 2 sections of RORS, (1 on each corresponding wall)
- If using 1x4 trim, install 4 sections of RORS (2 on each corresponding wall)



Outside Corner - Vertical Install

When two walls meet at an outside corner,

- If using aluminum trim, install 2 sections of RORS (1 on each corresponding wall)
- If using 1x4 trim, install 4 sections of RORS (2 on each corresponding wall)



HORIZONTAL/VERTICAL INSTALLATION ABOVE AND BELOW OPENINGS (windows, etc)

BELOW OPENINGS

- Measure 1/4" down from trim on both sides of opening
- Snap a chalk line from one end to the other (make sure line is level & straight)
- Measure and cut StarterStrip™ to the length of opening
- Install StarterStrip™ with flared angle at the top on the chalk line (the StarterStrip™ will be inverted)
- Nail every 8-16" into the framing
- Cut RORS to the length of opening
- Install RORS below the opening over top of StarterStrip™ (make sure the **top** edge of RORS is lined up with the angle of the StarterStrip™)

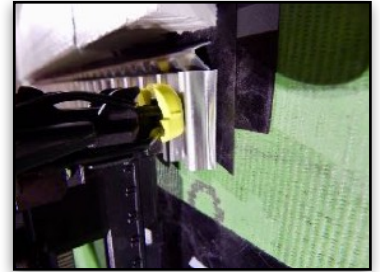

ABOVE OPENINGS

- Measure up 1/4" above z-flashing and snap chalk line
- Measure and cut StarterStrip™ to the length of opening
- Line up the bottom of StarterStrip™ with chalk line
- Nail every 8-16" into the framing
- Cut RORS to length of opening
- Install RORS above the opening (make sure the bottom is lined up with the angle of the StarterStrip™)



PLEASE CONTACT GGGS LLC FOR SPECIFIC INSTALLATION OVER ANGLED WALLS OR ANY ADDITIONAL QUESTIONS AT 402-686-4257. WWW.ROLLONRAINSYSTEM.COM



**HORIZONTAL
INSTALL**

**Roll-On Rainscreen™ installed
Horizontally over StarterStrip™
at top & bottom of Openings**
(See Detail*)

**Roll-On Rainscreen™ installed
Horizontally
over StarterStrip™
at top & bottom of Wall**
(See Detail*)

**Roll-On Rainscreen™
installed Horizontally
every 16" o.c.**

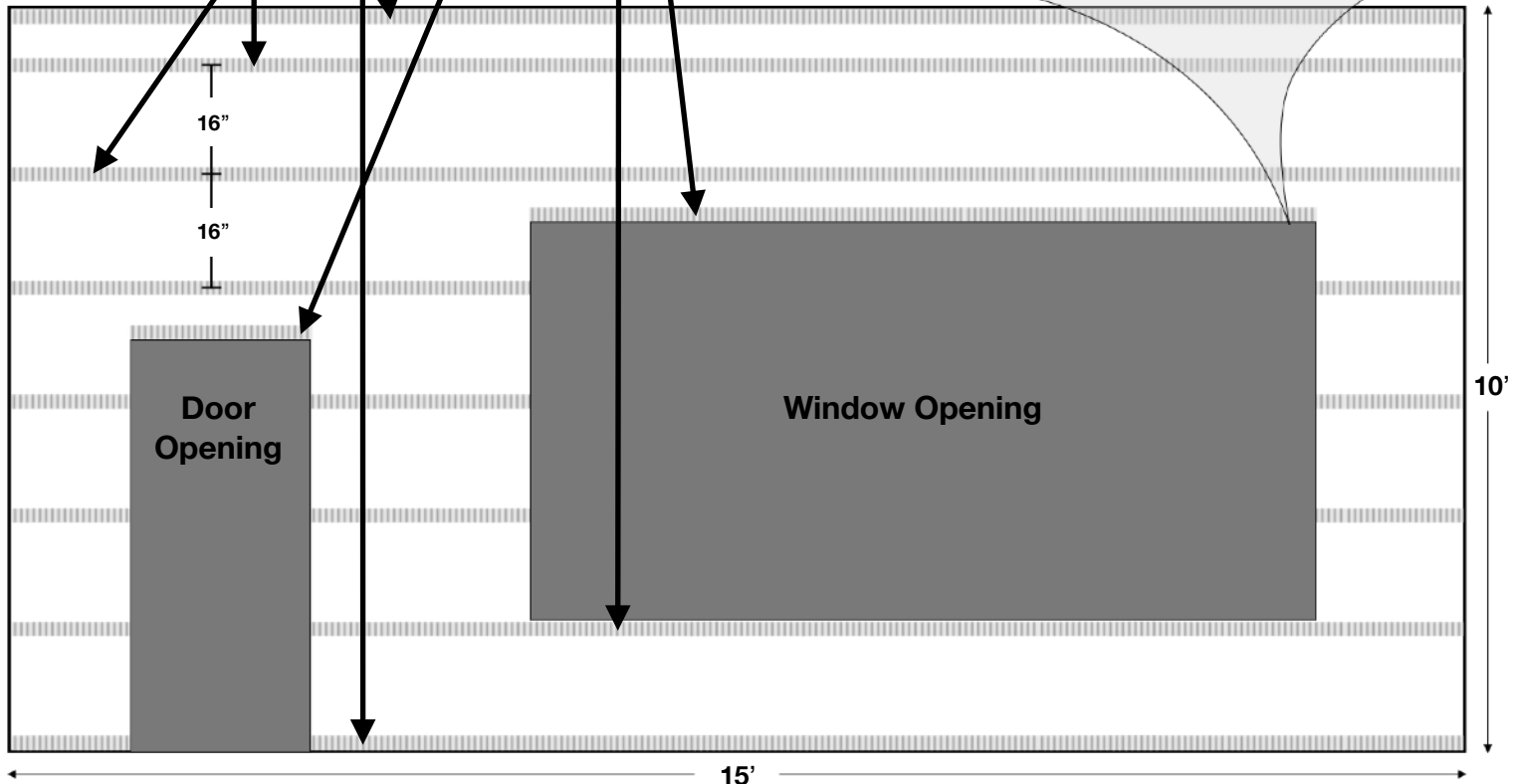

**Roll-On Rainscreen™ + StarterStrip™ Detail* at Top/
Bottom of Wall & Top/Bottom of Openings; sideview**

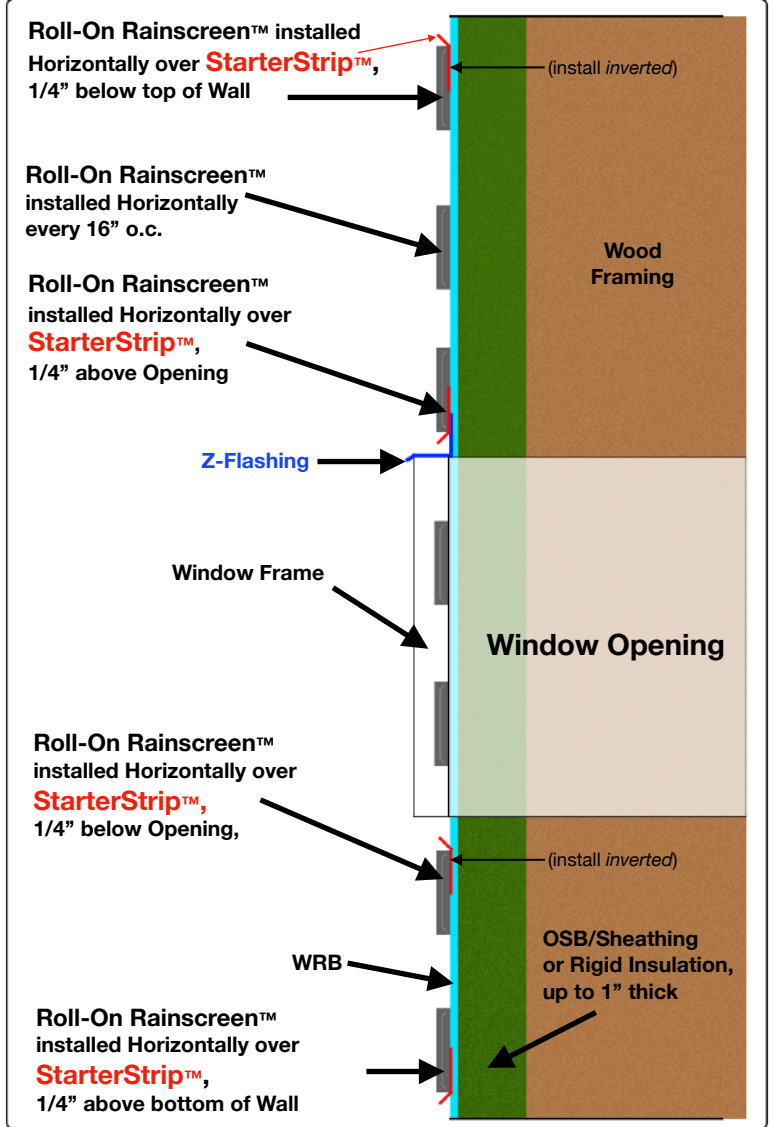



V E R T I C A L
 I N S T A L L A T I O N

Roll-On Rainscreen™ + StarterStrip™ Detail* at Top/Bottom of Wall & Top/Bottom of Openings; sideview

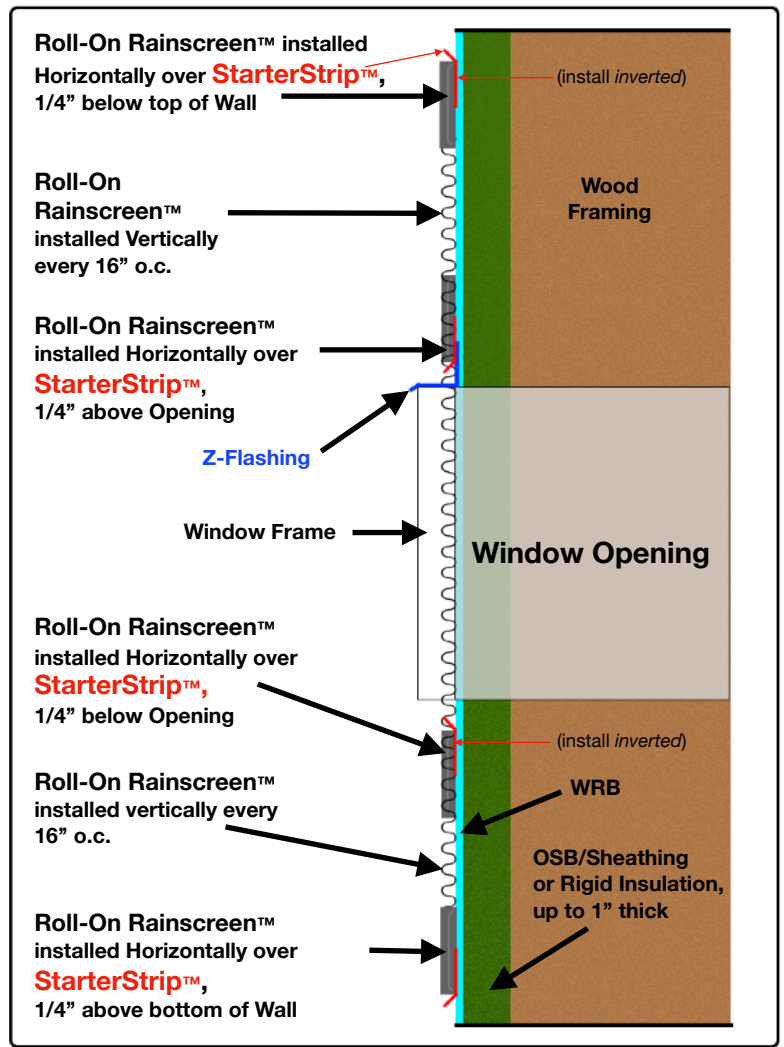

Roll-On Rainscreen™ installed Horizontally over StarterStrip™ at top & bottom of Openings
(See Detail*)

Roll-On Rainscreen™ installed Horizontally over StarterStrip™ at top & bottom of Wall
(See Detail*)

Roll-On Rainscreen™ installed Vertically every 16" o.c.

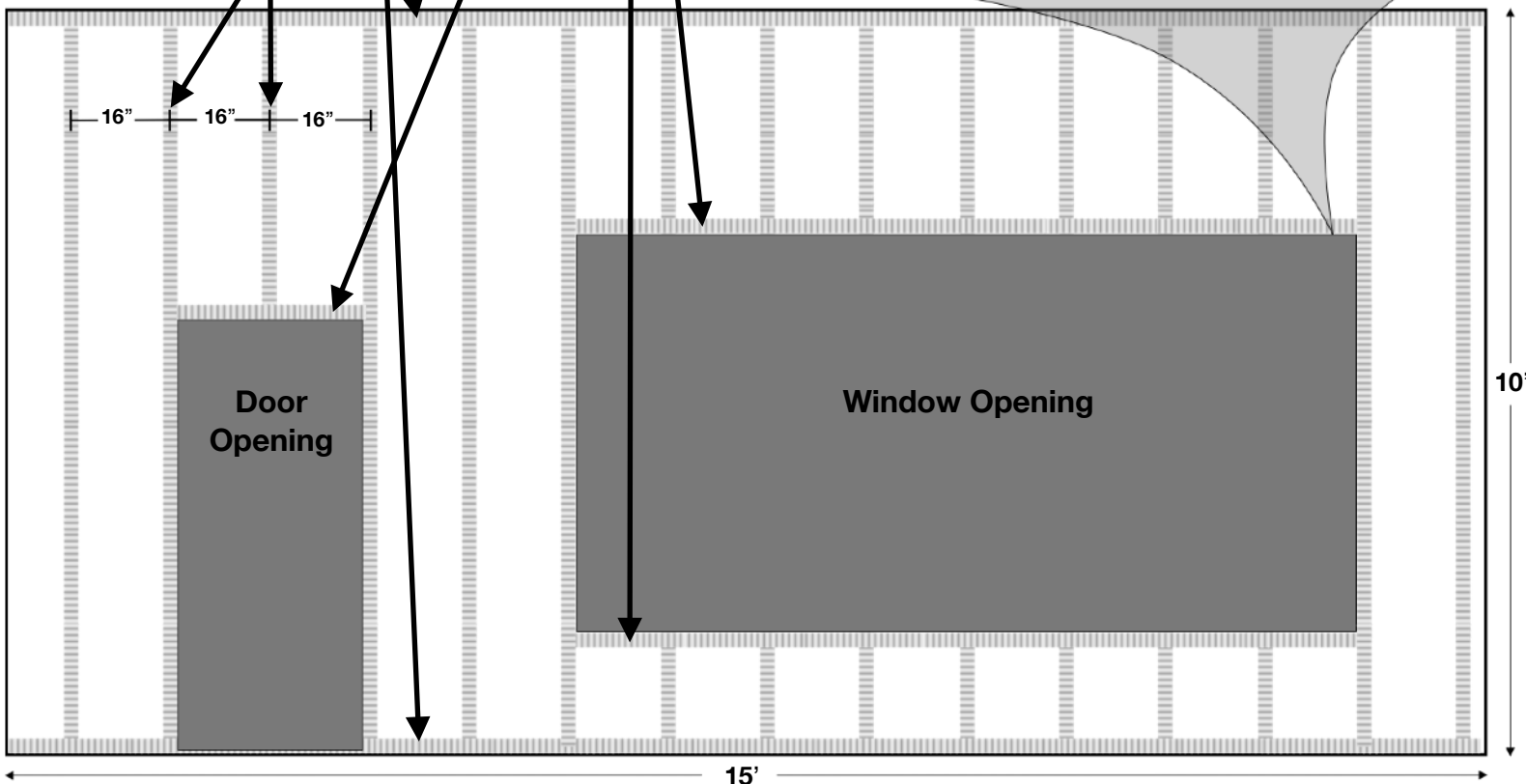

These illustrations are to be used as general guides only and do not account for the full details of any specific project. They are to be considered alongside any/all technical input from project owners, managers, engineers, architects, building code officials, contractors and installers. GGGS LLC accepts no liability in respects to the use of these drawings. Visit www.RollOnRainscreen.com for specific installation instructions.